

XPG GAMMIX S11 Pro PCIe Gen3x4 M.2 2280

**REMAINS COOL  
AT BLAZING  
SPEEDS**



## **XPG GAMMIX S11 Pro PCIe Gen3x4 M.2 2280 Solid State Drive**

Employing the extra-fast PCIe Gen3x4 interface and supporting NVMe 1.3, the GAMMIX S11 Pro delivers blazing fast read/write speeds of up to 3,500/3,000MB per second. What's more, the S11 Pro is encased in a heatsink that reduces the SSD's temperatures by up to 10°C. Equipped with 3D NAND Flash along with SLC Caching, a DRAM Cache Buffer, End-to-End Data Protection, and LDPC ECC technology, it maintains high speeds and data integrity even during intense gaming, rendering, overclocking, and other high-demand applications.

### **Features**

- Ultra-fast PCIe Gen3x4 interface:  
R/W speed up to 3500/3000MB/s
- SLC Caching and DRAM cache buffer
- NVMe 1.3 support
- 3D NAND Flash for higher capacity and durability
- Unique heatsink design – makes SSD 10°C cooler
- Advanced LDPC ECC Technology
- E2E Data Protection and RAID Engine
- Compact M.2 2280 form factor – ideal for gaming and high-end desktops

### **Ordering Information**

Capacity	Model Number	EAN Code
<b>1TB</b>	AGAMMIXS11P-1TT-C	4710273770772



- Capacities: 1TB
- NAND Flash: 3D TLC
- Interface: PCIe Gen3x4
- Form Factor: M.2 2280
- Controller: SM2262
- MTBF: 2,000,000 hours
- Dimensions (L x W x T): 80 x 22 x 6.1mm
- Weight: 11g / 0.38oz
- Power Consumption: 0.33W Active (Typical),  
0.14W Slumber (Typical) (\*measured by power meter)
- Operating Temperature: 0°C~70°C
- Storage Temperature: -40°C~85°C
- Shock Resistance: 1500G/0.5ms
- Warranty: 5-year limited
- Certifications: RoHS, CE, FCC, BSMI, VCCI, KC, RCM,  
UKCA, Morocco

## Performance

Capacity	Sequential Performance (Up to) <sup>1</sup>		4K Random (Up to) <sup>1</sup>		TBW <sup>2</sup>
	Read (MB/s)	Write (MB/s)	Read (IOPS)	Write (IOPS)	
1TB	3,500	3,000	390K	380K	640TB

<sup>1</sup>Performance may vary based on SSD capacity, hardware test platform, test software, operating system and other system variables

<sup>2</sup>The value is the minimum amount of terabyte written that could be reached.

## Schematics

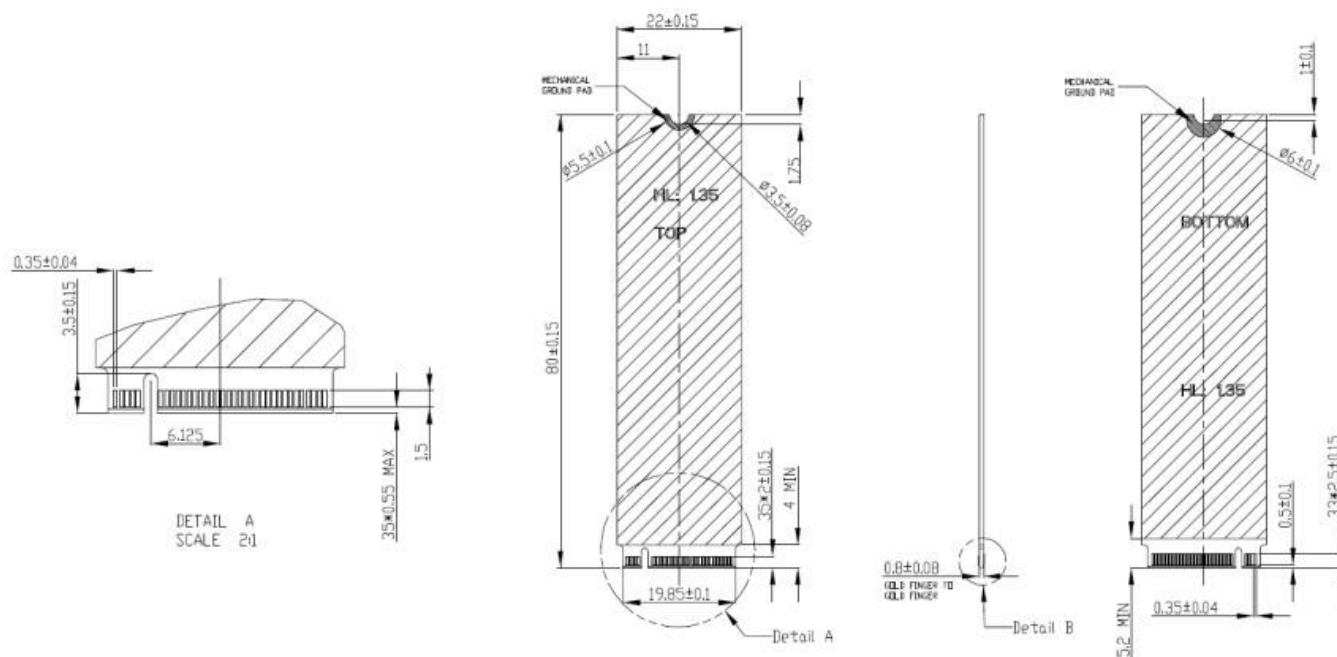

<b>UK</b>	<b>REP</b>	APEX CE SPECIALISTS LIMITED Address: 69 Princess Street, Manchester, M1 4HT, UK E-mail: <a href="mailto:adata_europe@adata.com">adata_europe@adata.com</a>
<b>EU</b>	<b>REP</b>	ADATA Technology B.V. Address: Transpospark, Sinusdreef 17-21 2132 WT, Hoofddorp, The Netherlands